

Bearing No. NKX 25

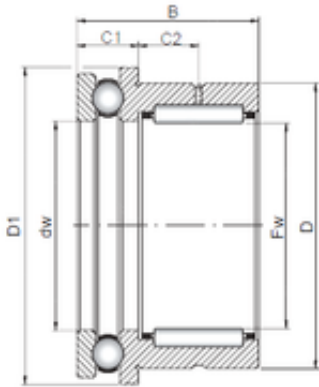

| | |
|--------------------------------|-------------|
| Size | 25x37x30 mm |
| Bore Diameter | 25 mm |
| Outer Diameter | 37 mm |
| Width | 30 mm |
| d | 25 mm |
| Fw | 25 mm |
| D | 37 mm |
| B | 30 mm |
| C1 | 11 mm |
| D1 | 42,1 mm |
| C2 | 9,5 mm |
| Weight | 0,125 Kg |
| Dynamic load rating radial (C) | 18,8 kN |
| Dynamic load rating axial (C) | 19,6 kN |
| Static load rating radial (C0) | 30,5 kN |
| Static load rating axial (C0) | 37,5 kN |